

Key

- Proposed double yellow lines
- Existing double yellow lines

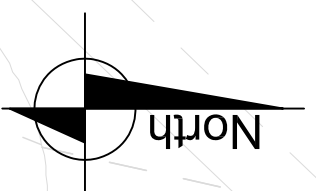
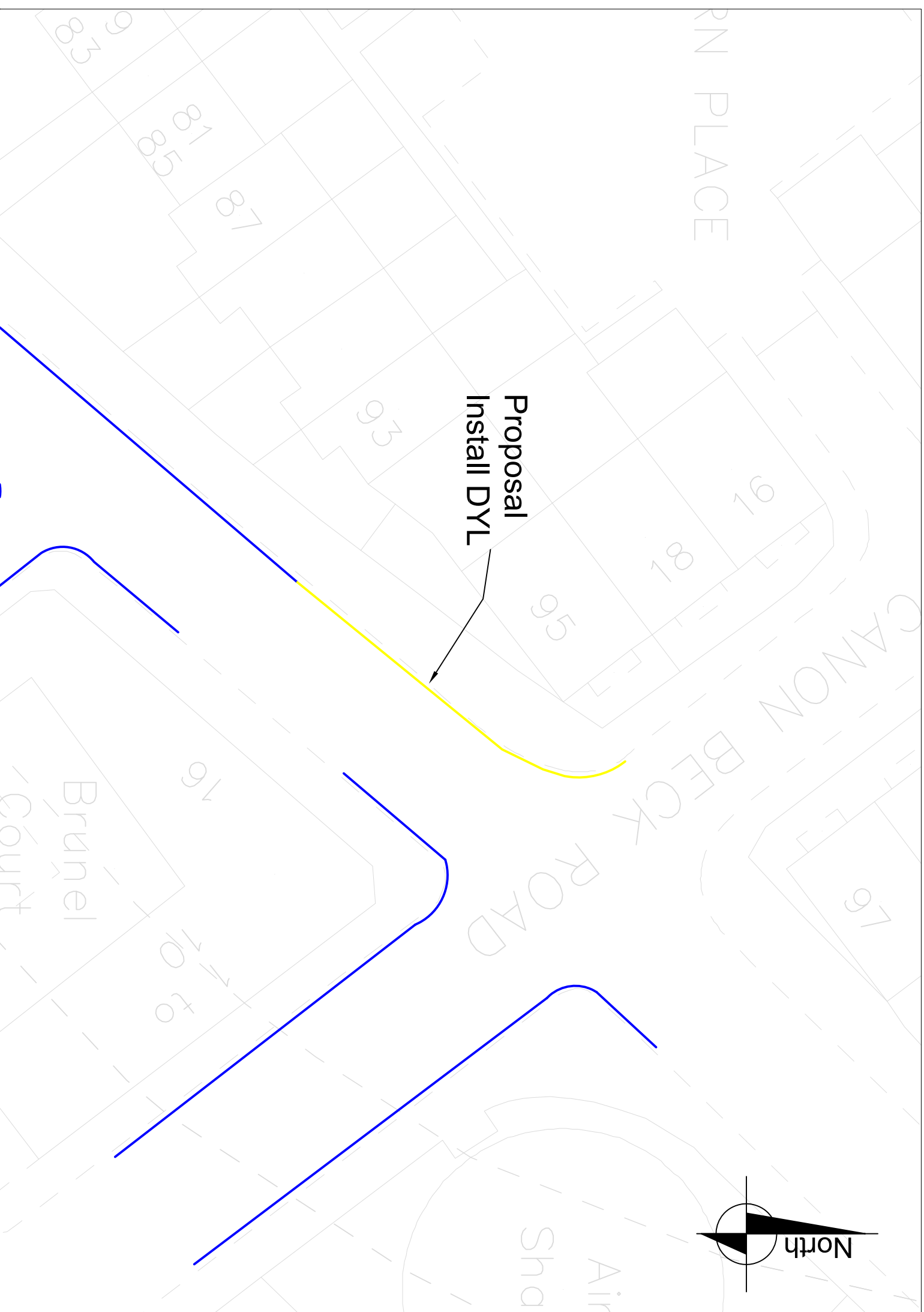

| Rev | Date | Description | Drm | Chk | App |
|-----|------------|-------------------------|-----|-----|-----|
| 1 | 08/11/2017 | Removal of Proposed DYL | TA | AS | MH |
| | | | | | |
| | | | | | |
| | | | | | |
| | | | | | |
| | | | | | |
| | | | | | |
| | | | | | |
| | | | | | |

Project
17/18 Minor Traffic Schemes - Q3

Drawing Title
Brunel Road - Extend double yellow lines

| | | | |
|---|----------------|------------------------|-----------|
| Community council Bermundsey and Rotherhithe | | Ward(s) Rotherhithe | |
| Date Oct 17 | Scale 1:250 | Drm TA | Rev AS |
| Drawing number 005_Brunel Road - TMO | Status | App RW | |

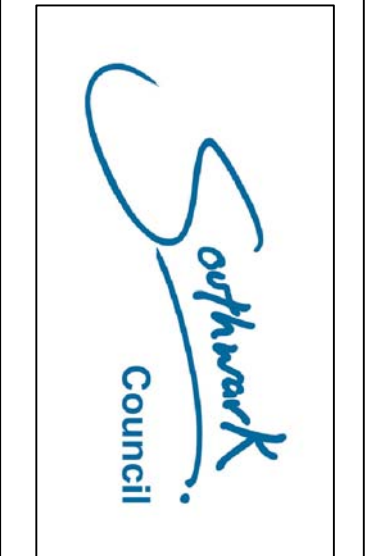

Highways Division
Transport projects
Minor Works

Environment and Social
 Regeneration
 Floor 3, Hub 2
 160 Todley Street
 PO Box 64529
 London SE1P 5LX